

OATLANDS HOUSE

# ROSE SUITE

FACT SHEET & FLOOR PLANS

OATLANDS HOUSE  
**Rose Suite**

**NAVARRA**  
EST 1973

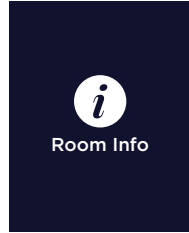

Room Info



Room Specs

**CAPACITIES**

  
Dinner & Dance  
60 - 160

  
Banquet Dinner  
60 - 190

  
Cocktail Party  
90 - 180

  
Theatre Seating  
60 - 196

**FEATURES**

- Ornate embellishments and petite chandeliers
- Elegant French interiors
- Feature marble fireplaces part of original manor
- Panelled bay window with Rose Garden views
- Welcome drinks area

**CONTACT US**

- Oatlands House  
42 Bettington Road  
Oatlands, NSW 2117
- 02 9683 3355  
oatlandshouse@navarra.com.au  
navarra.com.au

VENUE MAP

ROOM SPECS

LEVEL ONE

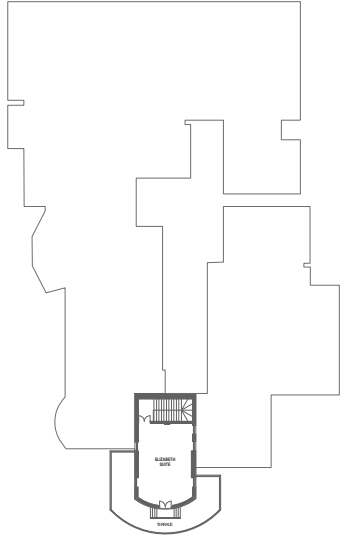

GROUND LEVEL

■ Rose Suite



- Ceiling Height 3.00 m
- Floor Area 162 m<sup>2</sup>
- Dance Area Not fixed

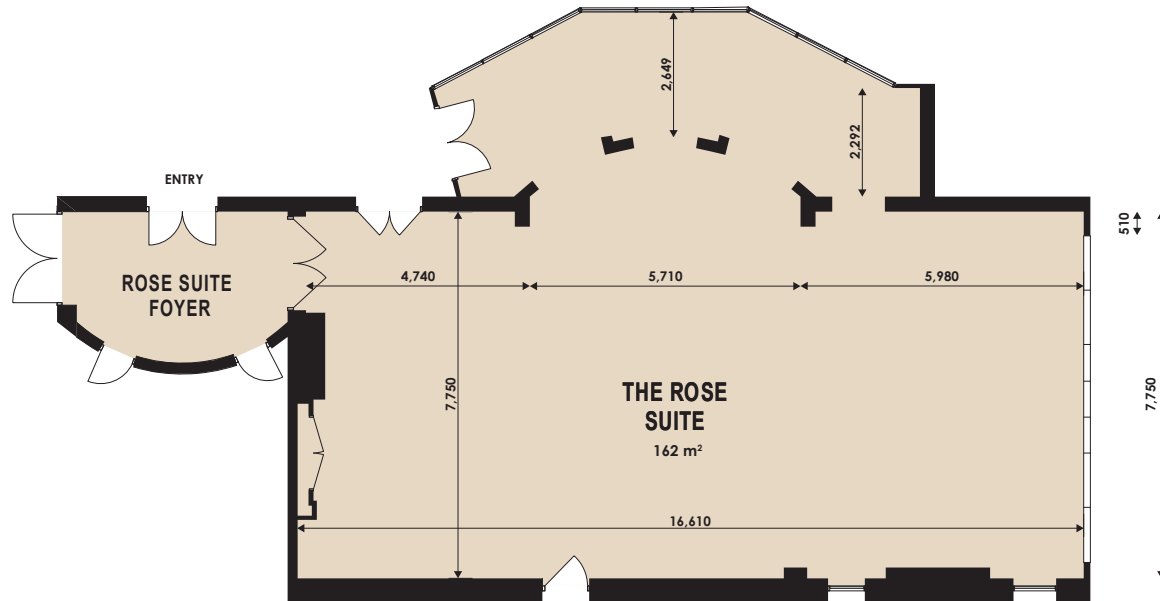

Room Info



Room Specs

CAPACITIES



Dinner & Dance  
 60 - 160



Banquet Dinner  
 60 - 190



Cocktail Party  
 90 - 180



Theatre Seating  
 60 - 196

**OATLANDS HOUSE**  
**Rose Suite**



**PAX PER TABLE**

- Round Tables  
8 Min - 10 Max
- VIP/Bridal Table  
8 Max

**SUITABLE FOR**

- Weddings
- Gala Dinners

**LEGEND**

-  Round Table
-  Don't use unless necessary
-  Alternative arrangement using Round Table instead

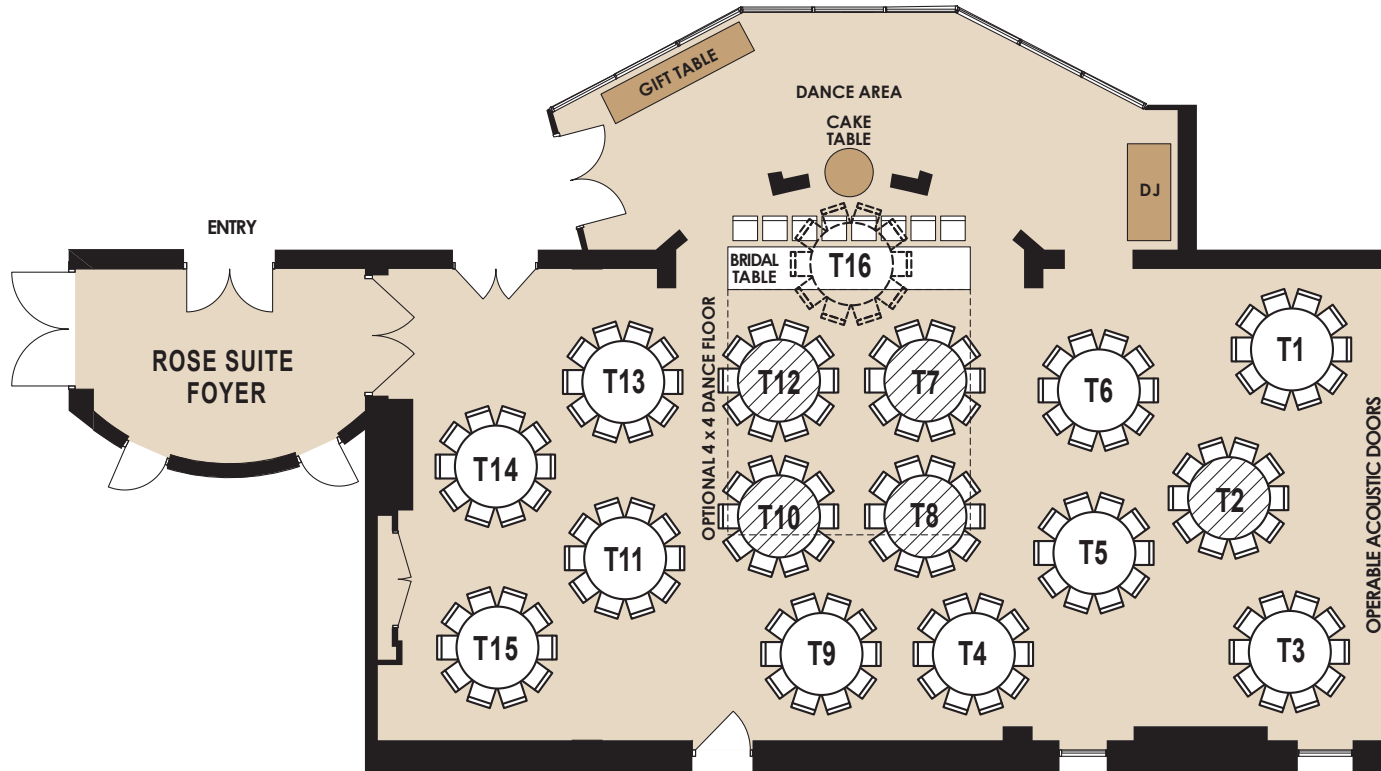

Room Info



Room Specs

**CAPACITIES**

  
 Dinner & Dance  
 60 - 160

  
 Banquet Dinner  
 60 - 190

  
 Cocktail Party  
 90 - 180

  
 Theatre Seating  
 60 - 196

**FOR OFFICIAL USE**

Event Name	Event Date
------------	------------

Please indicate on your floorplan additional requirements eg. band, photobooth, etc. These are subject to approval by your event stylist and coordinator.

OATLANDS HOUSE  
**Rose Suite**

**NAVARRA**  
 EST 1973



**PAX PER TABLE**

- Round Tables  
 8 Min - 10 Max

**SUITABLE FOR**

- Corporate Events

**LEGEND**

-  Round Table
-  Don't use unless necessary
-  Alternative arrangement using Round Table instead

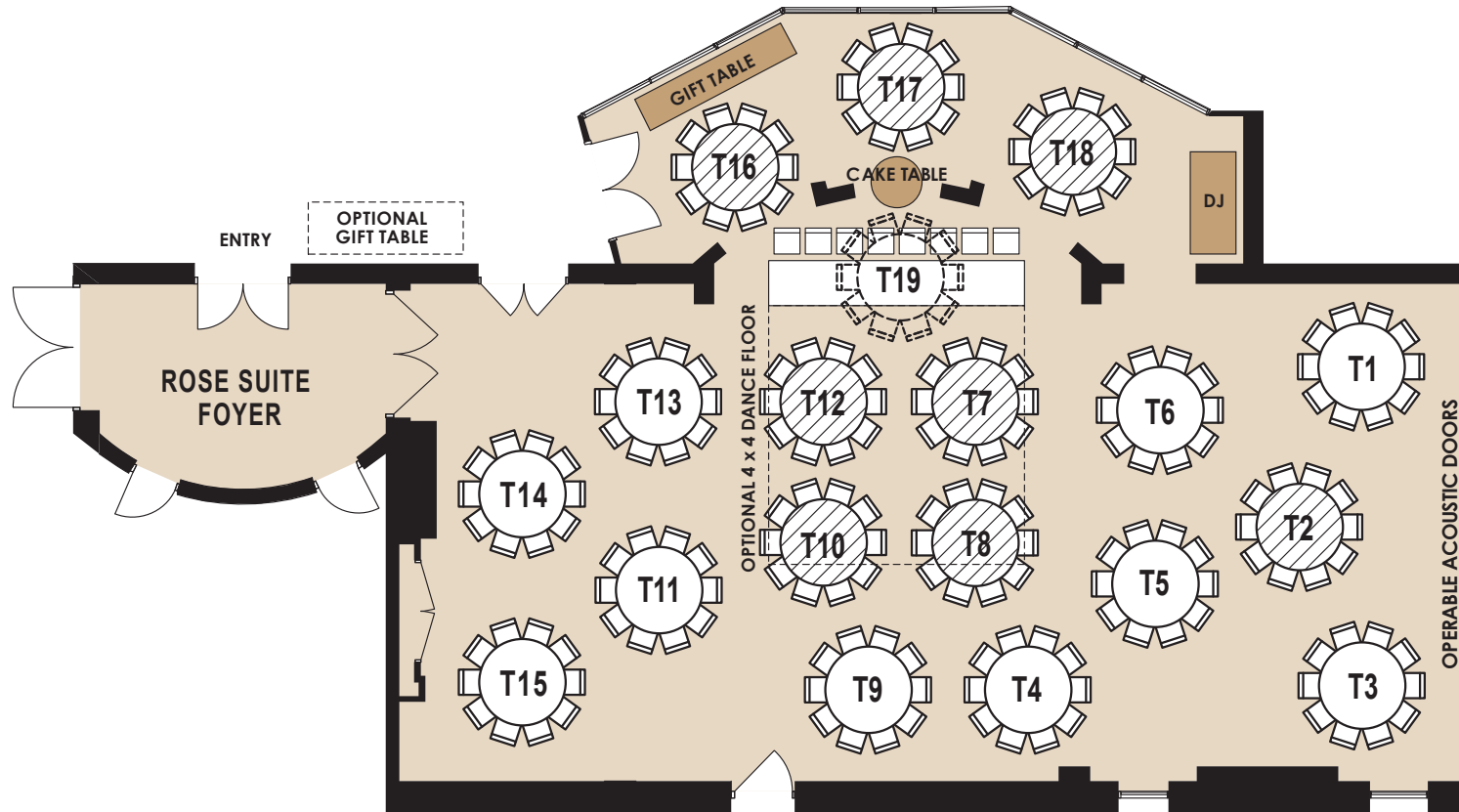

Room Info



Room Specs

**CAPACITIES**



Dinner & Dance  
 60 - 160



Banquet Dinner  
 60 - 190



Cocktail Party  
 90 - 180



Theatre Seating  
 60 - 196

**FOR OFFICIAL USE**

Event Name

Event Date

Please indicate on your floorplan additional requirements eg. band, photobooth, etc. These are subject to approval by your event stylist and coordinator.

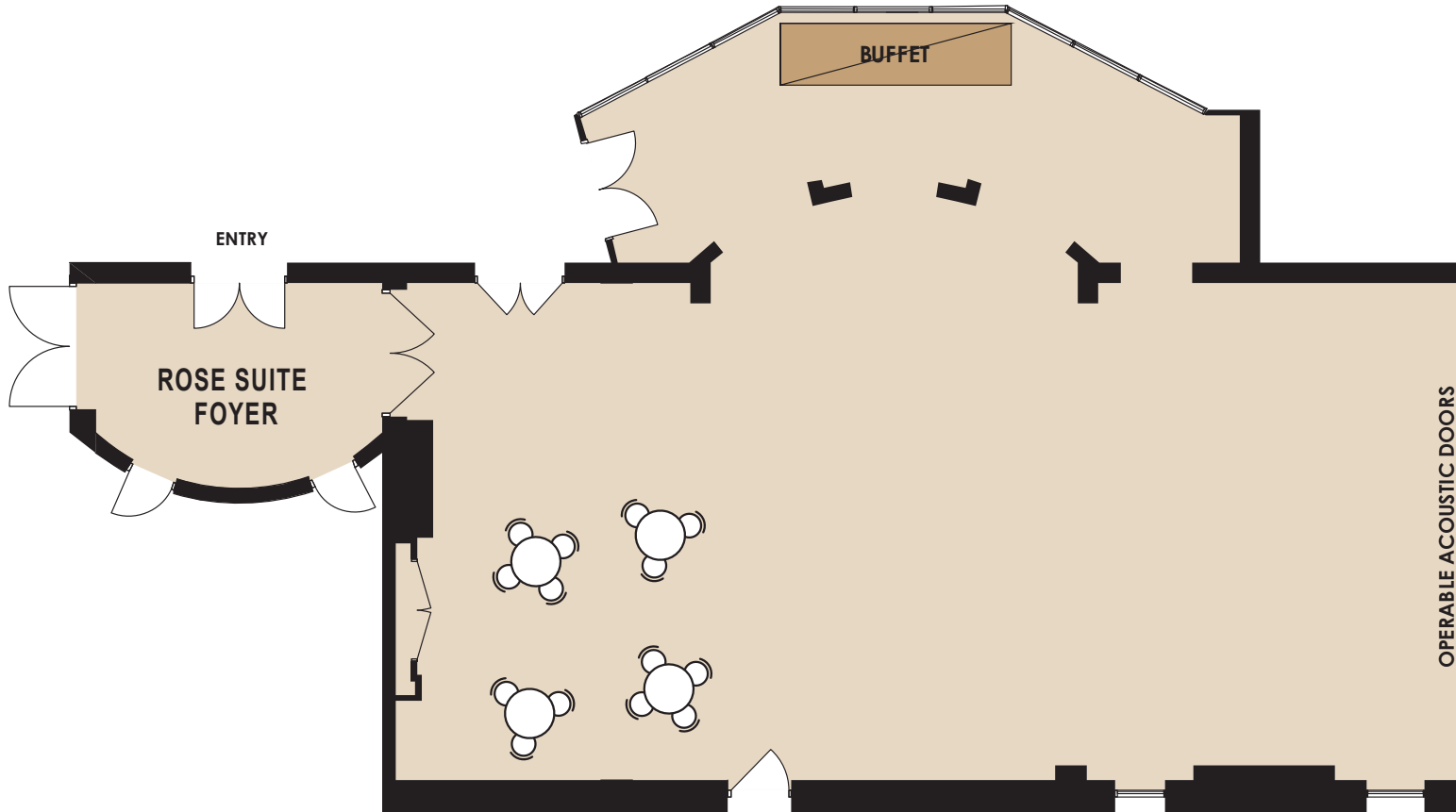

Room Info



Room Specs

**CAPACITIES**



Dinner & Dance  
 60 - 160



Banquet Dinner  
 60 - 190



Cocktail Party  
 90 - 180



Theatre Seating  
 60 - 196

**FOR OFFICIAL USE**

Event Name

Event Date

Please indicate on your floorplan additional requirements eg. band, photobooth, etc. These are subject to approval by your event stylist and coordinator.

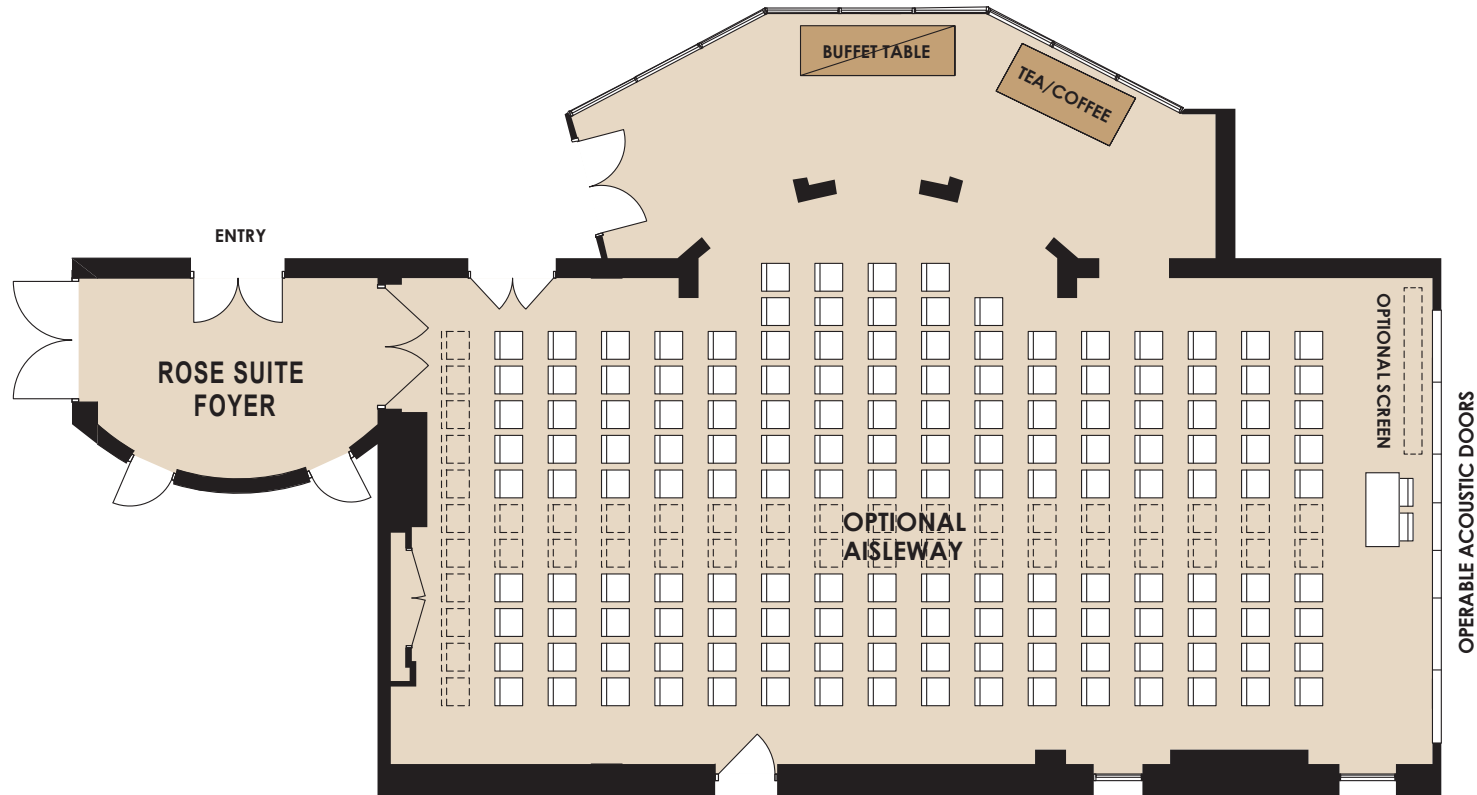

Room Info



Room Specs

**CAPACITIES**



Dinner & Dance  
 60 - 160



Banquet Dinner  
 60 - 190



Cocktail Party  
 90 - 180



Theatre Seating  
 60 - 196

**FOR OFFICIAL USE**

Event Name	Event Date
------------	------------

Please indicate on your floorplan additional requirements eg. band, photobooth, etc. These are subject to approval by your event stylist and coordinator.