

MONTAGE

SARAH GRAND BALLROOM

FACT SHEET & FLOOR PLANS

MONTAGE

Sarah Grand Ballroom

NAVARRA

EST 1973

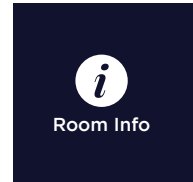

Room Info



Room Specs



AV Specs

CAPACITIES



Dinner & Dance
420 - 1020



Banquet Dinner
420 - 1100



Cocktail Party
630 - 1130



Theatre Seating
420 - 1110

FEATURES

- Stunning waterfront views
- Dedicated foyer
- Brand new outdoor Glass House
- Designer interiors and luxurious crystal chandeliers
- Welcome drinks area
- Heightened ceilings
- Lift Access

CONTACT US

- Montage
38 Frazer Street
Lilyfield, NSW 2040
- 02 9555 6099
montage@navarra.com.au
navarra.com.au

Sarah Grand Ballroom

VENUE MAP

LEVEL ONE

- Sarah Grand Ballroom

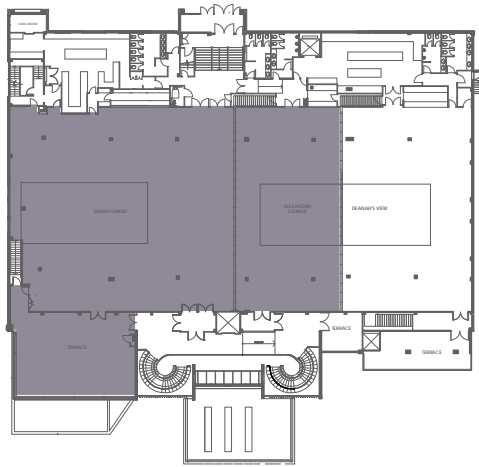

GROUND LEVEL

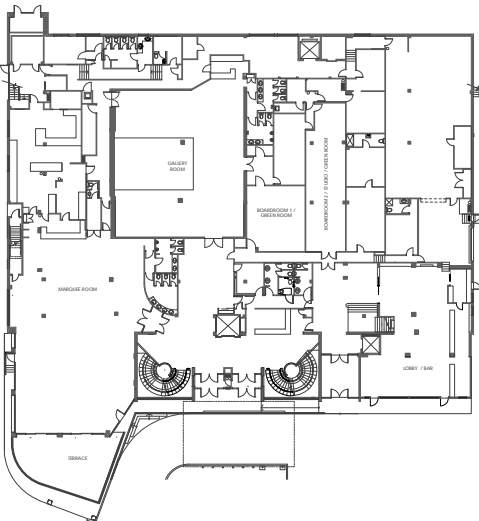

ROOM SPECS

- Ceiling Height 3.60 - 4.70 m
- Floor Area 926 m²
- Dance Floor Area 6.55 m x 14.70 m



Room Info



Room Specs



AV Specs

CAPACITIES



Dinner & Dance
420 - 1020



Banquet Dinner
420 - 1100



Cocktail Party
630 - 1130





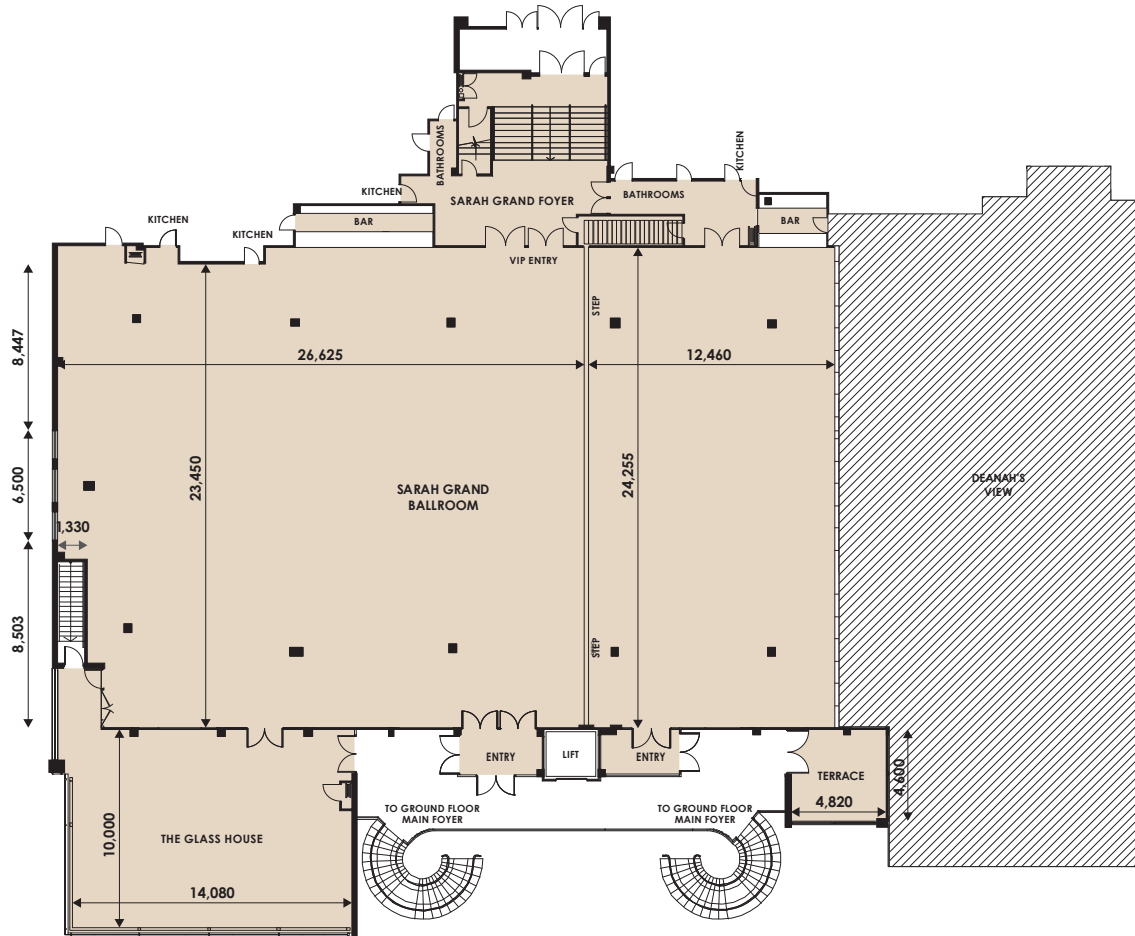



Theatre Seating
420 - 1110



Sarah Grand Ballroom

LEGEND

-  Strobe Light
-  Speakers
-  RP Light
-  Rigging Bar
-  Screens
-  Projectors

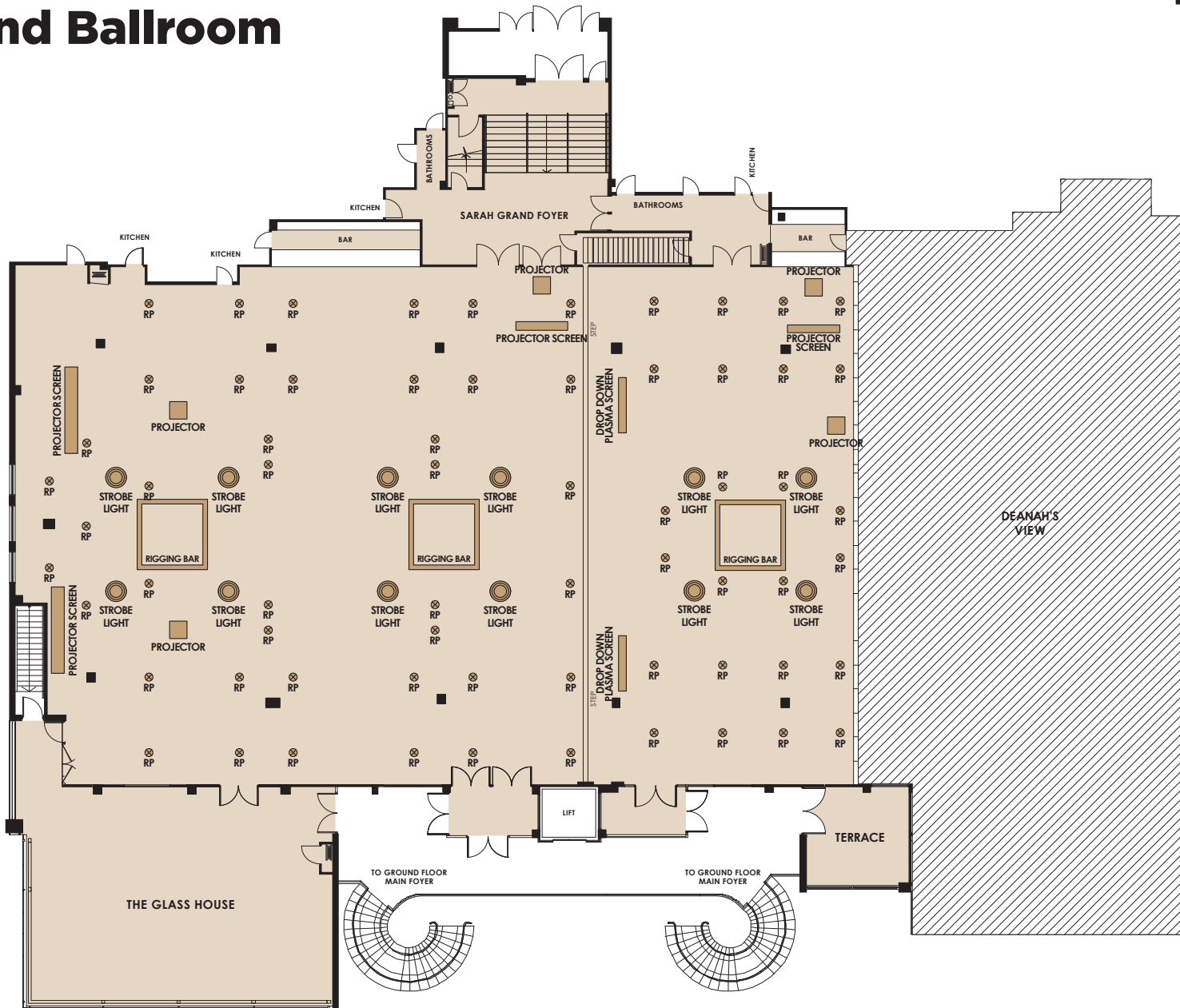

Room Info



Room Specs



AV Specs

CAPACITIES



Dinner & Dance
420 - 1020



Banquet Dinner
420 - 1100



Cocktail Party
630 - 1130



Theatre Seating
420 - 1110

Sarah Grand Ballroom

PAX PER TABLE



■ Round Tables
8 Min – 10 Max

■ VIP/Bridal Table
14 Max

SUITABLE FOR

- Weddings
- Gala Dinners

LEGEND

-  Round Table
-  Don't use unless necessary
-  Alternative arrangement using Round Table instead

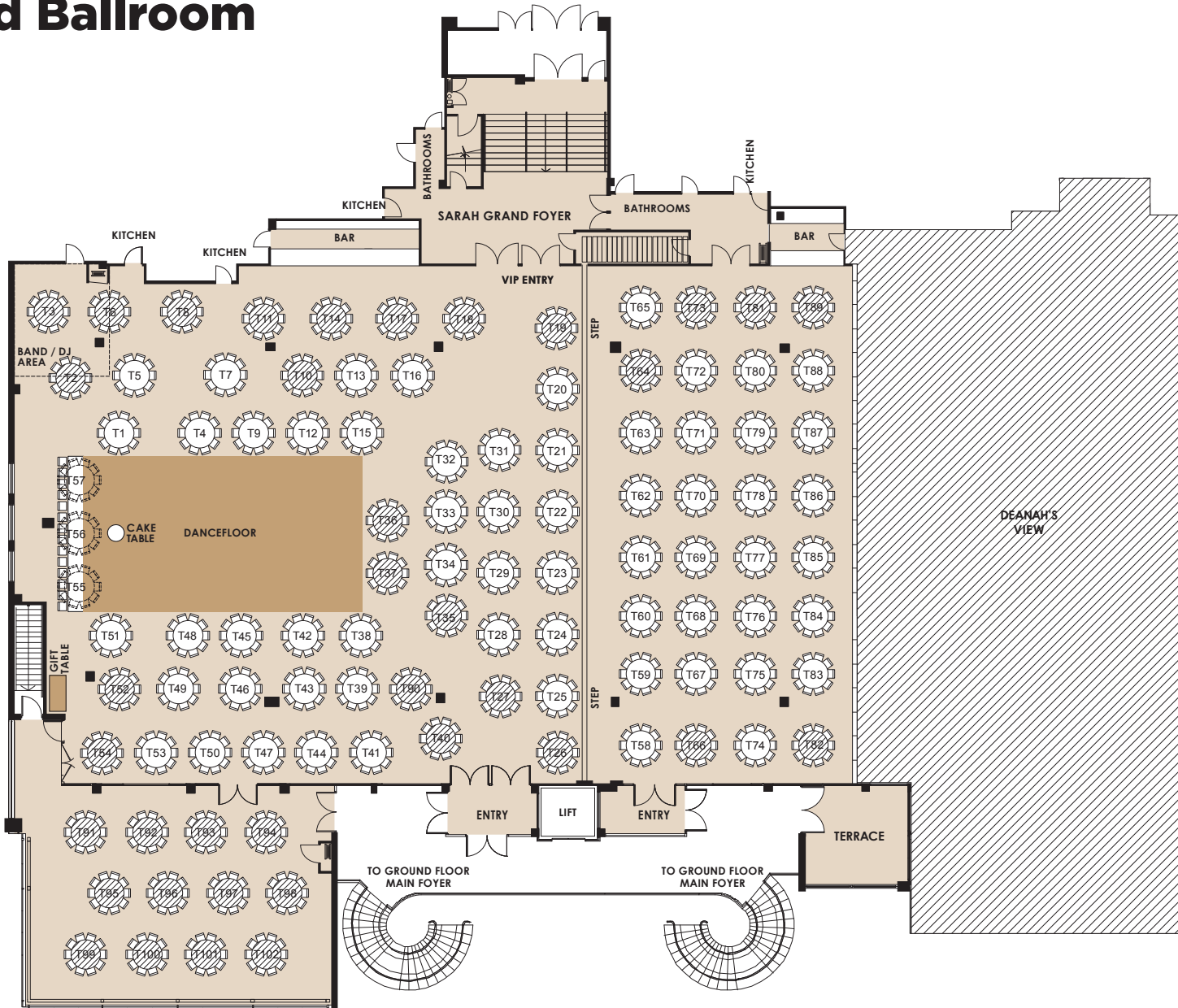

Room Info



Room Specs



AV Specs

CAPACITIES



Dinner & Dance
420 – 1020



Banquet Dinner
420 – 1100



Cocktail Party
630 – 1130



Theatre Seating
420 – 1110

FOR OFFICIAL USE

Event Name

Event Date

Please indicate on your floorplan additional requirements eg. band, photobooth, etc. These are subject to approval by your event stylist and coordinator.

MONTAGE

Sarah Grand Ballroom

NAVARRA

EST 1973



PAX PER TABLE

- Round Tables
8 Min - 10 Max

SUITABLE FOR

- Corporate Events

LEGEND

-  Round Table
-  Don't use unless necessary
-  Alternative arrangement using Round Table instead

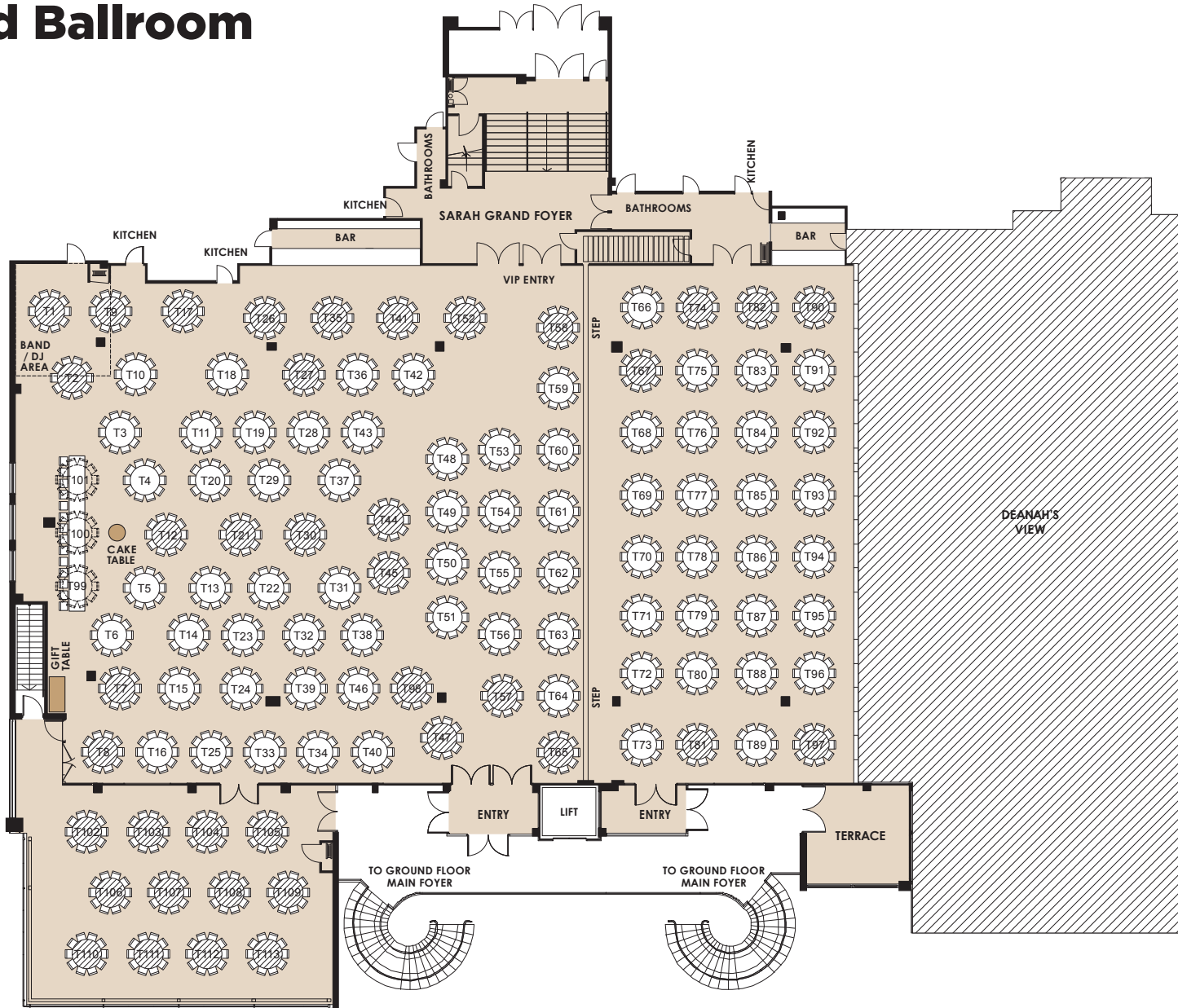

Room Info



Room Specs



AV Specs

CAPACITIES



Dinner & Dance
420 - 1020



Banquet Dinner
420 - 1100



Cocktail Party
630 - 1130



Theatre Seating
420 - 1110

FOR OFFICIAL USE

Event Name

Event Date

Please indicate on your floorplan additional requirements eg. band, photobooth, etc. These are subject to approval by your event stylist and coordinator.

MONTAGE

Sarah Grand Ballroom

NAVARRA

EST 1973

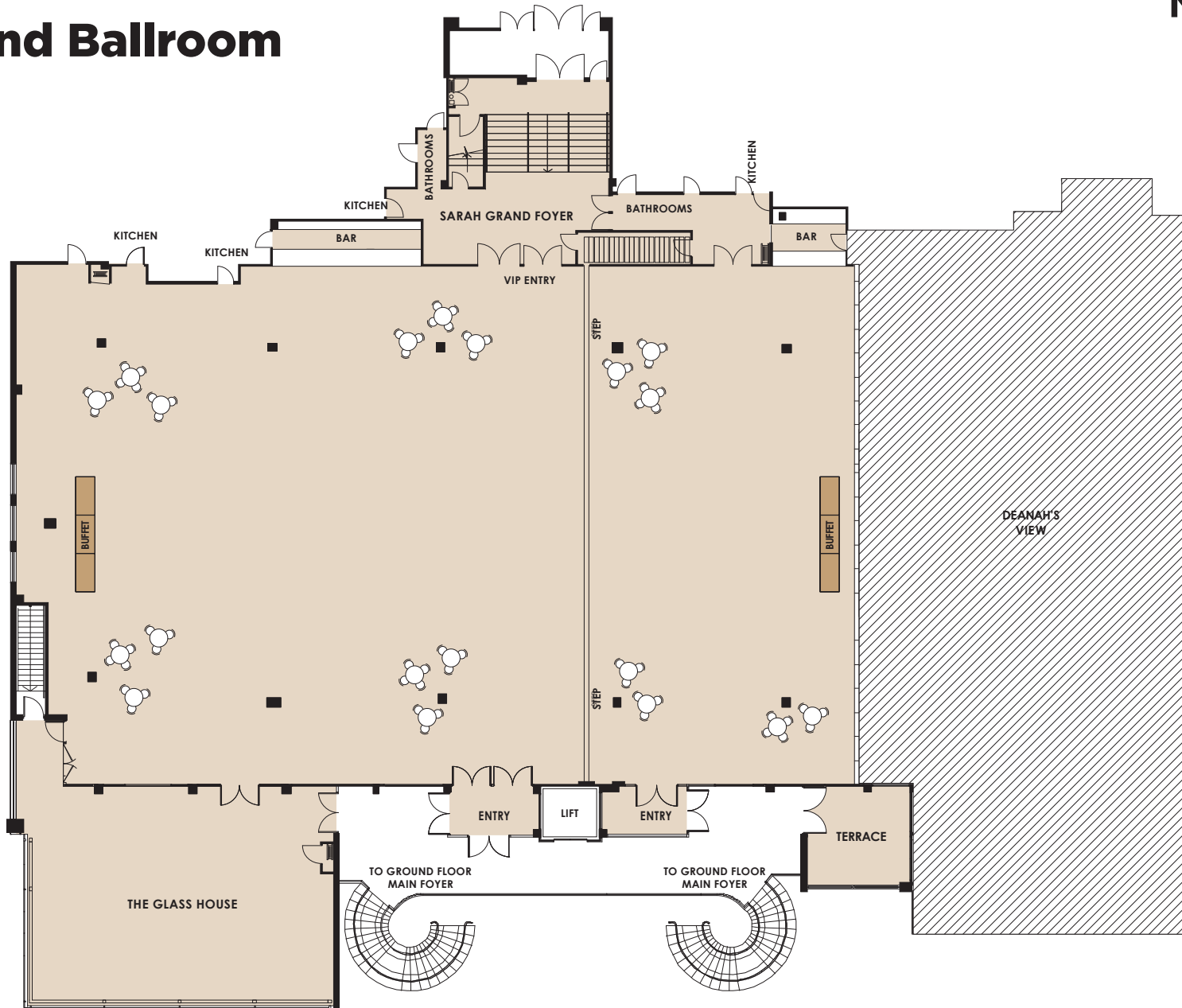

Room Info



Room Specs



AV Specs

CAPACITIES



Dinner & Dance
420 - 1020



Banquet Dinner
420 - 1100



Cocktail Party
630 - 1130



Theatre Seating
420 - 1110

FOR OFFICIAL USE

Event Name

Event Date

Please indicate on your floorplan additional requirements eg. band, photobooth, etc. These are subject to approval by your event stylist and coordinator.

Sarah Grand Ballroom

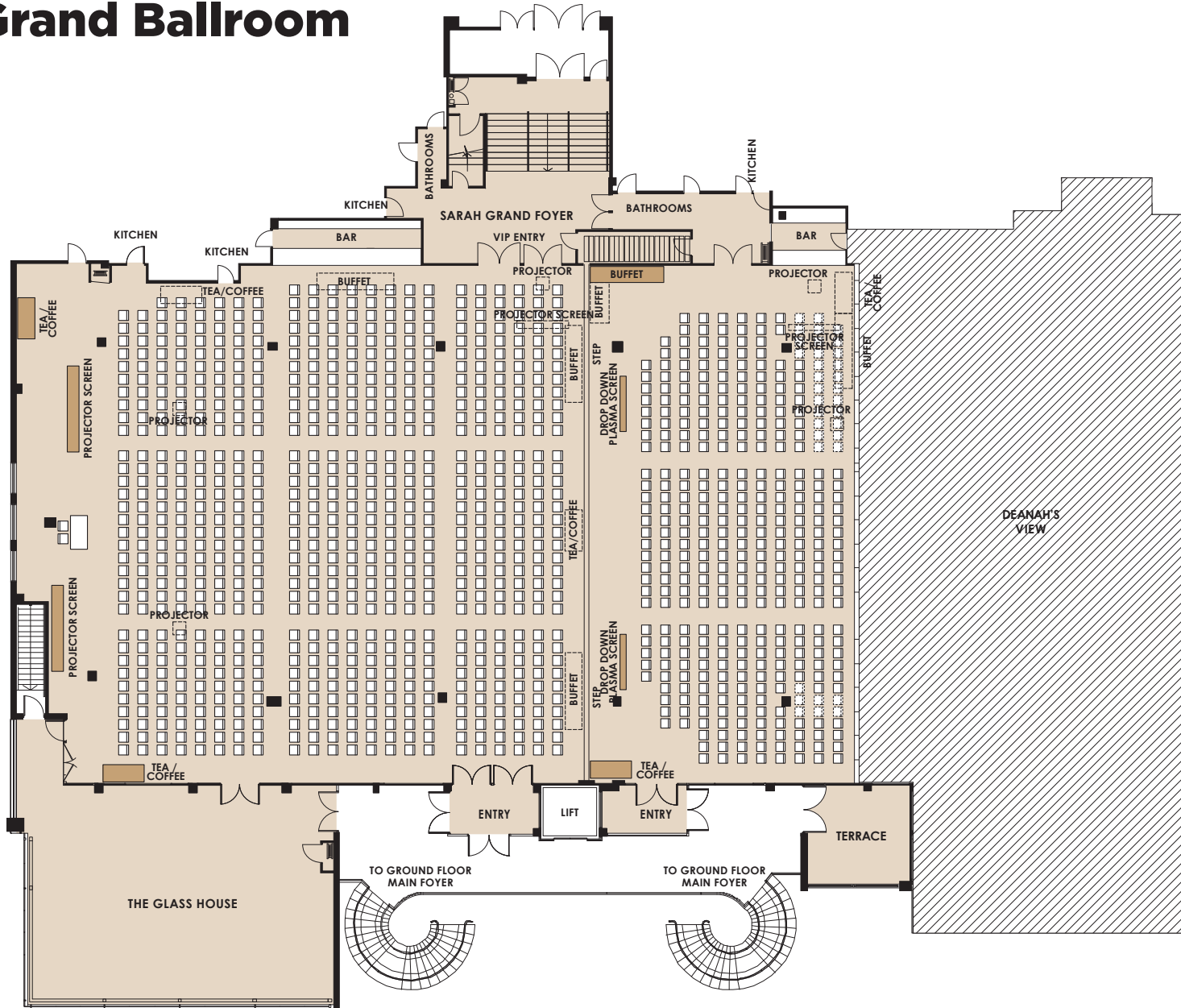

Room Info



Room Specs



AV Specs

CAPACITIES



Dinner & Dance
420 - 1020



Banquet Dinner
420 - 1100



Cocktail Party
630 - 1130



Theatre Seating
420 - 1110

FOR OFFICIAL USE

Event Name

Event Date

Please indicate on your floorplan additional requirements eg. band, photobooth, etc. These are subject to approval by your event stylist and coordinator.